

GRAVELLY®

CLARKE-GRAVELLY CORPORATION
A Studebaker-Worthington Company

OPERATOR'S MANUAL

**NAME: STEERING BRAKE KIT
FOR 5000 SERIES TRACTORS**

PART NUMBER(S): 23378



The steering brake kit fits the 5000 Series tractors only. The kit will not fit the 500 Series nor the 7.6 tractors.

The wheel brakes are designed to assist in steering the tractor and have a parking lock feature.

All references to "left hand", "right hand", "front" and "rear" are given from the operator's position.

To continue its program of quality and design improvement, the manufacturer reserves the right to change specifications, designs and prices without notice and incurring obligation.

Form No. 24344 (2-78)

Printed in U.S.A.

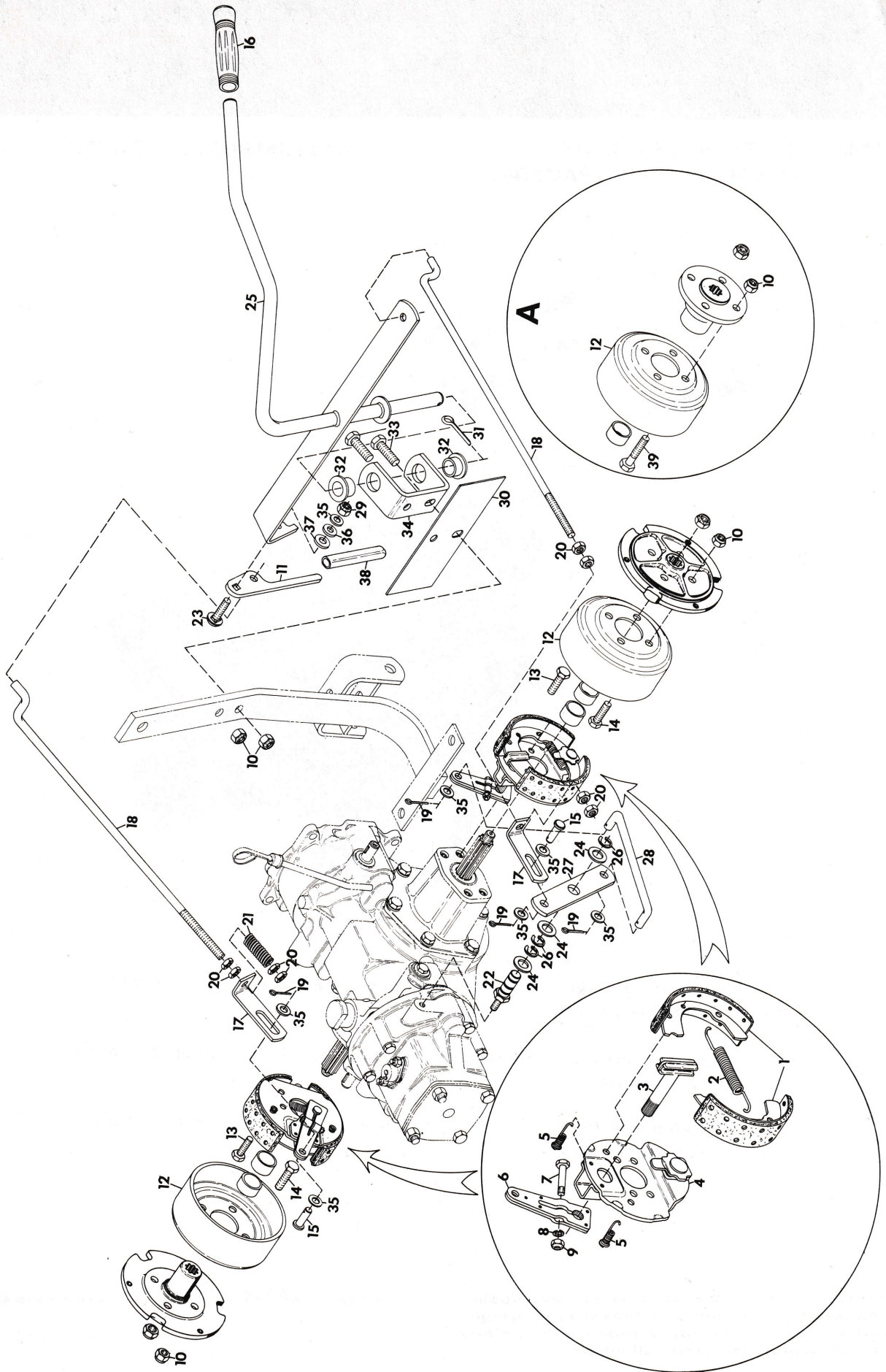

<u>ITEM NO.</u>	<u>PART NO.</u>	<u>QTY.</u>	<u>DESCRIPTION</u>
1	23539	2	Kit, Brake Shoe
2	23508	2	Spring, Shoe Return
3	23506	2	Cam, Brake
4	23507	2	Plate, Back
5	23509	4	Spring, Shoe Retaining
6	23505	2	Arm, Cam Lever
7	181618	2	Bolt, Hex; 5/16-24 x 1.750
8	120214	2	Washer, Lock; 5/16 SP
9	120368	2	Nut, Hex; 5/16-24
10	435507	10	Nut, Lock; 1/2-13 Washer Insert
11	23391	1	Handle, Parking Brake
12	23385	2	Drum, 7 x 1.75
13	9428638	8	Bolt, Hex; 3/8-16 x .625
14	180176	8	Bolt, Hex; 1/2-13 x 1.375
15	413227	2	Pin, Clevis; .375 x .594
16	10671	1	Grip, Hand
17	23389	2	Bracket, Adjustment
18	23390	2	Rod, Brake
19	121222	4	Pin, Cotter; .09 x .75
20	124829	8	Nut, Jam; 3/8-16
21	23392	1	Spring, Compression
22	23386	1	Stud, Pivot
23	126411	1	Bolt, 3/8-16 x 1.500 RD HD SQ NK
24	131016	3	Washer, Flat; .656 x 1.312 x .095
25	23379	1	Weldment, Brake Handle Bar
26	18053	3	E-Ring; .625 Shaft
27	23387	1	Plate, Pivot
28	23388	1	Rod, Brake Link
29	456004	1	Nut, Lock; 3/8-16 Washer Insert
30	23383	1	Plate, Instruction
31	103409	1	Pin, Cotter; .188 x 1.500
32	18355	2	Bushing, Pivot
33	180179	2	Bolt, Hex; 1/2-13 x 1.750
34	23382	1	Support, Brake Handle
35	120394	7	Washer, Flat; .406 x .812 x .065
36	23394	1	Washer, Rubber; .375 x .750 x .125
37	20775	1	Washer, Nylon; .375 x .75 x .060
38	23393	1	Grip, Parking Brake Handle
39	180178	8	Bolt, Hex; 1/2-13 x 1.625

OPERATION

Read the tractor's Operator's Manual and become familiar with the controls and their function before attempting to use the brakes.

Move the brake handlebar to the right to make the tractor turn to the left.

Move the brake handlebar to the left to make the tractor turn to the right. See fig. 2.

Do not use the brake when backing the tractor. Use the handlebars of the tractor for steering when backing.



Fig. 2

1 — Brake Handlebar

PARKING

To engage the parking brake, stop tractor, disengage PTO, put the forward/reverse and high-lo gear in neutral. Pull parking brake lock lever back and up. See fig. 3.

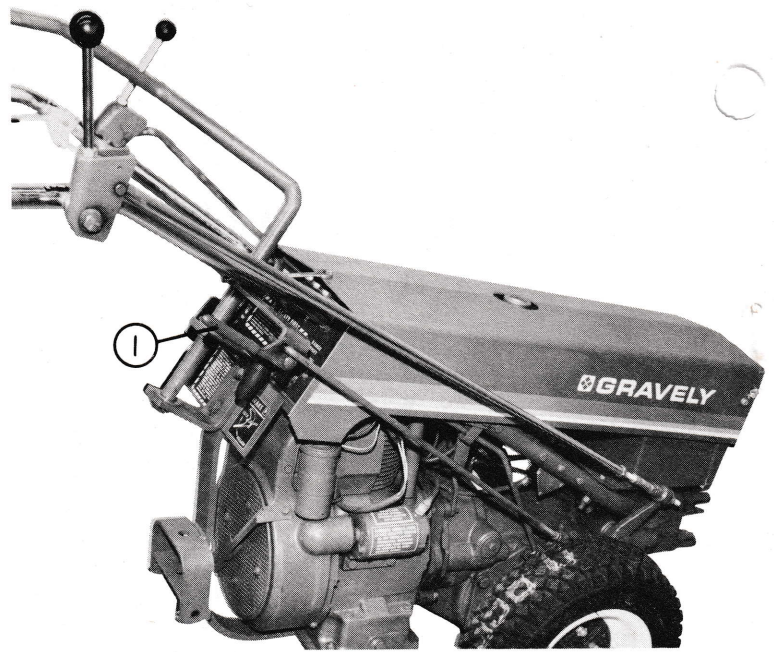

Fig. 3

1 — Parking Brake Lock Lever

To disengage the parking brake, push the parking brake lock lever down and forward. See fig. 4.

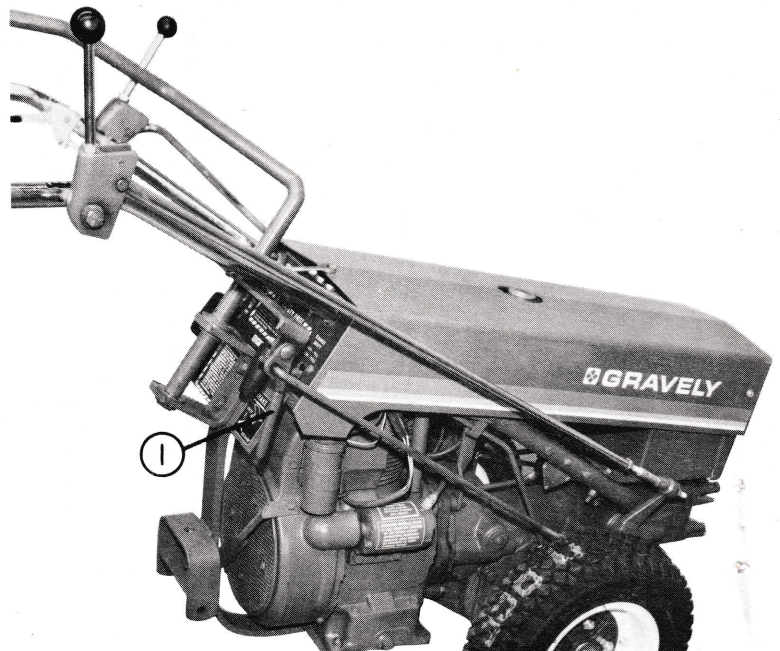

Fig. 4

1 — Parking Brake Lock Lever

CLEANING THE BRAKES

Wash the brake assemblies with hose and water. Dirt will cause excessive wear on the brake linings and brake drums.

BRAKE ADJUSTMENT

1. Loosen the jam nuts on the right and left brake rods. See figs. 5 & 6.

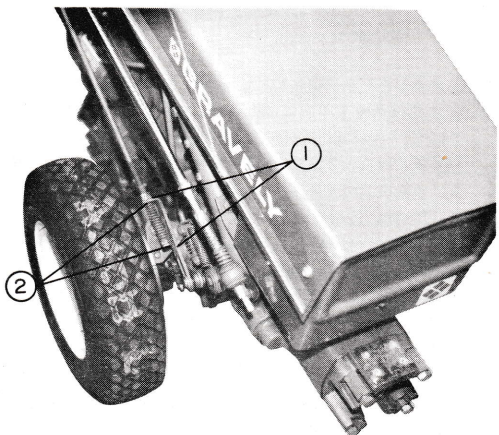

Fig. 5

- 1 — Jam Nuts
- 2 — Adjusting Nuts

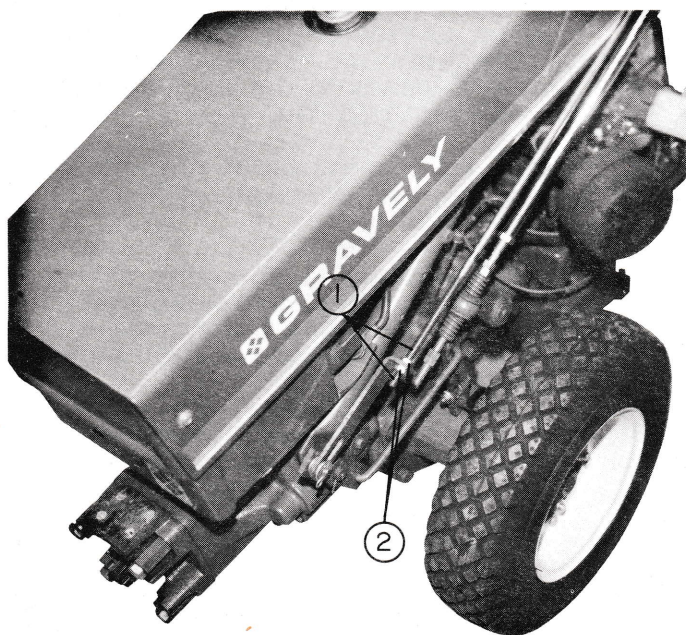

Fig. 6

- 1 — Jam Nuts
- 2 — Adjusting Nuts

2. Turn the adjusting nuts on the brake rods until the cross weldment is parallel to the instrument panel. The brake handlebar should have a slight amount of free movement to assure that the brakes are not too tight. See fig. 7.

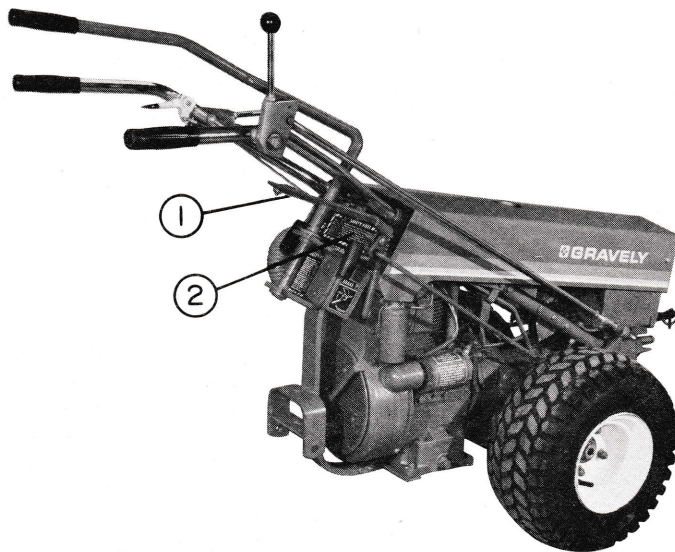

Fig. 7

- 1 — Cross Weldment
- 2 — Instrument Panel

3. After making the adjustments, check the free movement of the wheels by pushing or pulling the tractor with engine stopped and all controls in neutral. If either wheel drags, re-adjust.
4. If wheels move freely, move the brake handle bar to the right while pushing on the right handlebar of the tractor. This should activate the left wheel brake. If it does not, re-adjust.
5. Move the brake handlebar to the left while pulling on the right handlebar of the tractor. This should activate the right wheel brake. If it does not, re-adjust.
6. Engage the parking brake lock. Check to make sure both wheel brakes are engaging properly. If both brakes do not engage, re-adjust.
7. When brakes are properly adjusted, tighten the jam nuts against the adjusting nuts.



ATTACHMENT LIMITED WARRANTY

This Limited Warranty is issued by Clarke-Gravely Corporation, Gravely Division, and consists of the following terms:

1. Only the original purchaser of new Gravely manufactured attachments is covered by this Warranty.
2. This Warranty covers repair or replacement of parts manufactured by Gravely which are defective in material or workmanship. Gravely will pay for parts and labor only.
3. The Warranty starts the date of purchase and lasts for NINETY (90) DAYS for attachments used in Roofer applications, and TWELVE (12) MONTHS for products used in all other applications.
4. Some components of Gravely attachments are not covered by the Gravely Warranty. These components are covered by the original manufacturer's warranty. They are:
 - (a) Tires - Goodyear, Goodrich, Armstrong, General and Firestone
5. To obtain warranty service on Gravely attachments including components not manufactured by Gravely, use this procedure:
 - (a) Notify the Gravely dealer from whom you purchased the attachment.
 - (b) If you have moved and it is not convenient to notify the selling dealer, notify the nearest Gravely dealer. You should supply this dealer with a copy of the bill of sale as proof of the date of purchase.
 - (c) Make arrangements to have the attachment delivered to the dealer (refer to paragraph 6(a) below).
 - (d) If you have any questions concerning the Gravely Warranty, they should be referred to:

Gravely
Clarke-Gravely Corporation
A Studebaker-Worthington Company
One Gravely Lane
Clemmons, N. C. 27012
Attn: Manager of Customer Services
 - (e) Warranty service on Gravely attachments must be performed by an authorized Gravely dealer or Gravely factory branch.

6. This Warranty does not cover the following:
 - (a) Transportation between owner's home or place of business and the dealership. If the dealer provides the transportation of the attachment, he will charge the owner his usual rate for such service.
 - (b) Normal maintenance services and normal replacement of items such as belts lubricants, mower, plow or cultivator blades.
7. GRAVELY MAKES NO OTHER EXPRESS WARRANTIES. ANY IMPLIED WARRANTIES, INCLUDING WARRANTIES AS TO MERCHANTABILITY OR FITNESS FOR A PARTICULAR PURPOSE, ARE LIMITED IN DURATION TO THE PERIOD SET OUT IN PARAGRAPH 3 ABOVE. SOME STATES DO NOT ALLOW LIMITATIONS ON HOW LONG AN IMPLIED WARRANTY LASTS, SO THE ABOVE STATEMENT MAY NOT APPLY TO YOU.
8. GRAVELY SHALL HAVE NO RESPONSIBILITY FOR INCIDENTAL OR CONSEQUENTIAL DAMAGES RESULTING FROM THE BREACH OF ANY WARRANTY, INCLUDING, BUT NOT LIMITED TO, INCONVENIENCE, RENTAL OR PURCHASE OF REPLACEMENT EQUIPMENT, LOSS OF PROFITS OR COMMERCIAL LOSS. SOME STATES DO NOT ALLOW THE EXCLUSION OR LIMITATION OF INCIDENTAL OR CONSEQUENTIAL DAMAGES, SO THE ABOVE LIMITATION OR EXCLUSION MAY NOT APPLY TO YOU.
9. This Warranty gives you specific legal rights, and you may have other rights which vary from state to state.
10. A Gravely registration card is supplied with each Gravely attachment. Please complete the card and return it to Gravely at the address listed on the card. The registration card will be used by Gravely for:
 - (a) Recording date of purchase.
 - (b) Notification of owners in compliance with the Consumer Product Safety Act, should any notification be necessary.The return of registration card is not required in order to take advantage of this Warranty.
11. This Warranty is not subject to change or modification by anyone, including Gravely dealers and no Gravely dealer is authorized to make any representations or promises on Gravely's behalf.